



Nozzles designed to fuel tomorrow's clean energy vehicles



# THE JC CARTER LNG NOZZLE SMALL SINGLE LINE CRYOGENIC COUPLING

- » The only small cryogenic coupling available in the industry
- » One motion mating for connection and operation
- » World-renowned JC Carter customer service
- » Built-in safety "shut-off" valve feature



JC Carter  
 671 West 17th Street  
 Costa Mesa, CA 92627-3605 USA  
 Phone: +1.949.764.2200  
 Fax: +1.949.258.5072  
[marketingteam@jccarterpumps.com](mailto:marketingteam@jccarterpumps.com)  
[www.jccarternozzles.com](http://www.jccarternozzles.com)



# Small Single Line Cryogenic Coupling

## PN 50E722 and PN 50E721

### DESCRIPTION

The redesigned JC Carter Single Line Cryogenic Fuel Coupling is designed for no-vent fueling stations. New seals and poppet ensure problem-free operation. The coupling is connected to the receptacle and activated through a 1/4 turn motion.

The receptacle mounts on the tank of the LNG fueled vehicle. For added safety, both the coupling and receptacle incorporate independent shut-off valves which prevent LNG flow if forced separation occurs.

### FEATURES

- » One motion mating for connection and operation
- » Compact, lightweight design
- » Patented sealing orientation prevents leakage while fueling
- » Sturdy construction designed to survive harsh fleet fueling facility environment
- » Fewer parts allows easy maintenance

### LNG COUPLING APPLICATIONS

- » Fluid Compatibility - LNG, Methane, LN2, many other cryogenic fluids
- » Bus Air Venting
- » Garbage Truck Air Venting
- » Ideal for Future Small LNG Vehicles

### SPECIFICATIONS

Rated Flow.....10 GPM  
 Max Refueling Pressure.....250 PSIG  
 Max Working Pressure.....500 PSIG  
 Burst Pressure.....1500 PSIG  
 Spillage on Demating.....< 1 cc  
 Storage Temp.....-60° F to 120° F  
 Operating Temp.....-320° F to 120° F  
 Leakage while Fueling.....None

#### Nozzle

Weight.....1.2 lbs  
 Port Size.....1/2" NPTF  
 Material of Construction.....Stainless Steel, Aluminum, Brass

#### Receptacle

Weight.....0.4 lbs  
 Port Size.....1/2" NPTF  
 Material of Construction.....Stainless Steel, Brass



PN 50E722  
10 GPM LNG Nozzle



PN 50E721  
10 GPM LNG Receptacle

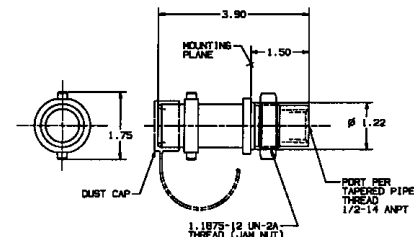

Receptacle 50E721

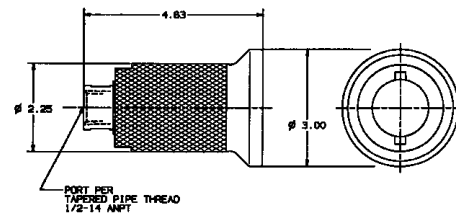

Nozzle 50E722

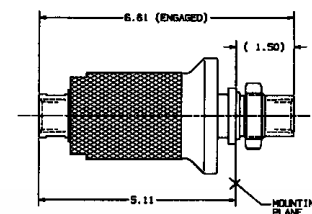

JC Carter  
 671 West 17th Street  
 Costa Mesa, CA 92627-3605 USA  
 Phone: +1.949.764.2200 • Fax: +1.949.258.5072  
 marketingteam@jccarterpumps.com • www.jccarternozzles.com